

ALEKS Student Experience on Smartphones



This document contains information, data and/or analysis (collectively, “Information”) that is confidential and proprietary to McGraw-Hill Education (the “Company”). The Information is intended solely for internal access and use by Company employees and may not be disclosed or distributed, in whole or in part, to any outside party, except that with the written authorization of a Business Unit President or the Company’s Legal Department, information may be disclosed to partners, vendors, contractors or consultants of the Company to the extent they are contractually obligated to maintain the confidentiality of such information. All employees are reminded of their obligations under the McGraw-Hill Education Code of Business Ethics, which apply both during and after their employment with the Company, to maintain the confidentiality of commercially sensitive or proprietary information relating to the Company that comes into their possession.

Overall Mobile Limitations of New Student Module

Current Mobile Limitations of New Student Module:

- Text is small
- Buttons/input boxes difficult to interact with
- Inefficient use of space
- Celebrations not optimized
- Headers too cluttered
- Inability to Zoom in/out (temporary; being fixed by Dev)

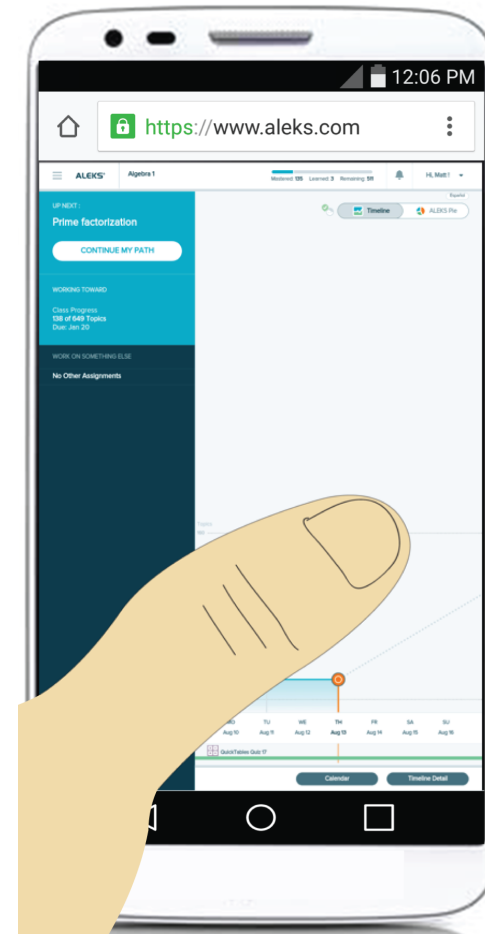

Homepage

- Space – Timeline, Work On Something Else not optimized for mobile devices
- Continue My Path not prominent
- Top header too detailed
- Text difficult to read

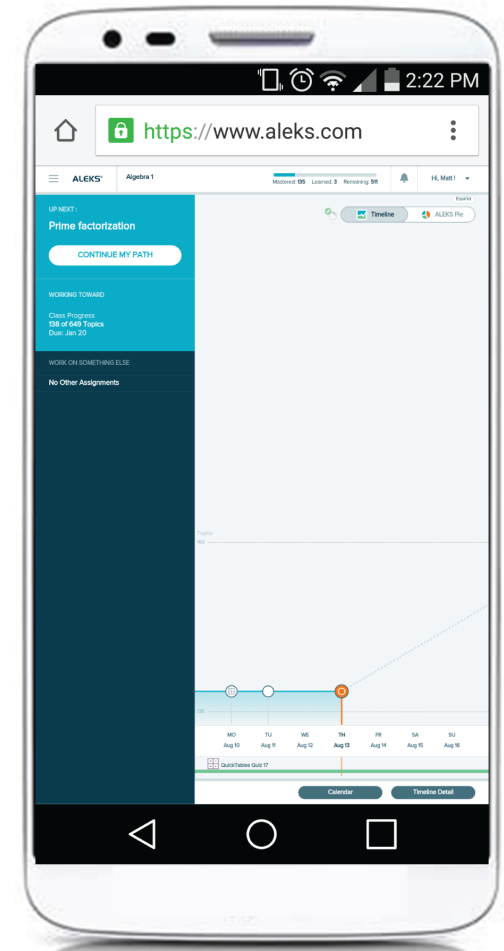

Hamburger Menu

- Menu items too small
- Width of hamburger menu should be increased

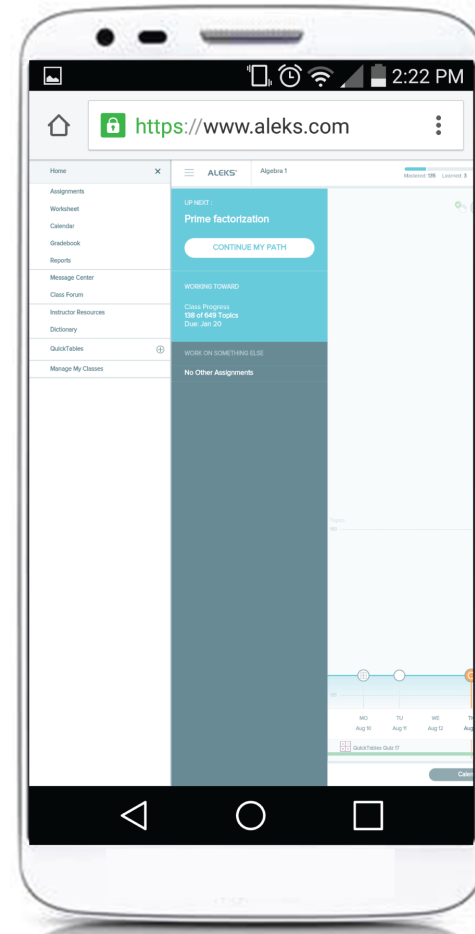

Reports

- Similar issues with regard to space and text size
- Swipe not obvious
- Pagination controls too far from content
- Links on pie report too small to select

Dashboard

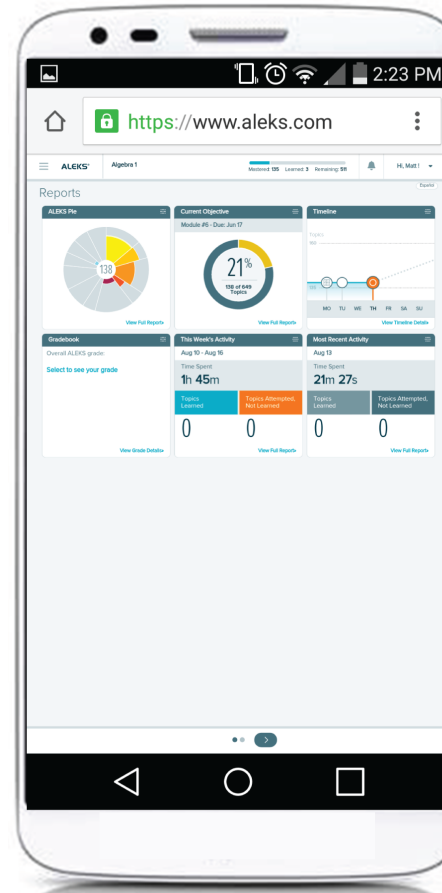

Pie Report

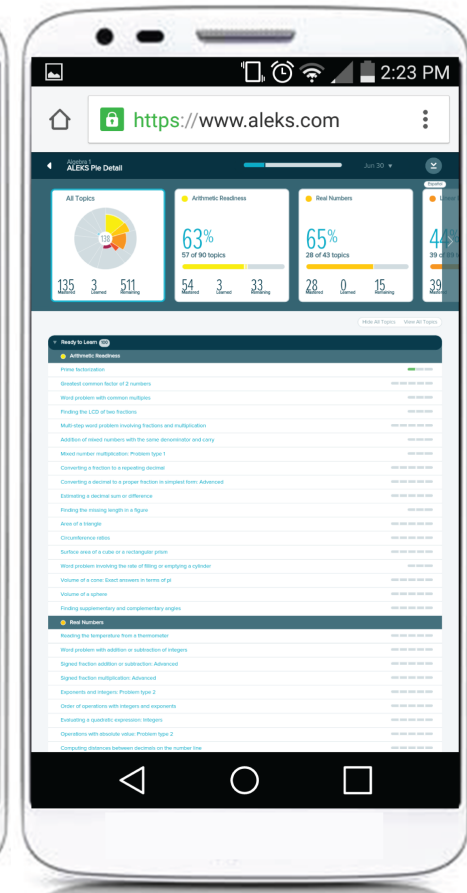

Learning

- Small input boxes
- Learning walk barely visible
- Carousel card size too small
- Carousel pull-down tab too small

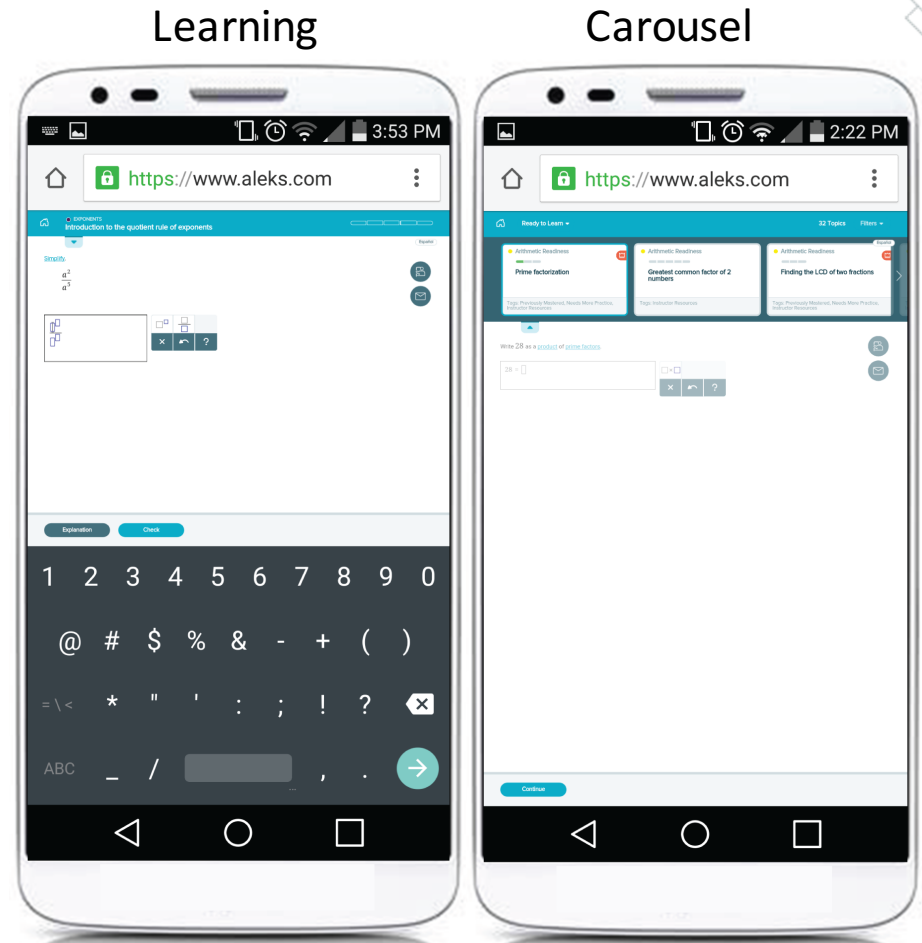

Celebrations

- Not optimized
- Effect reduced

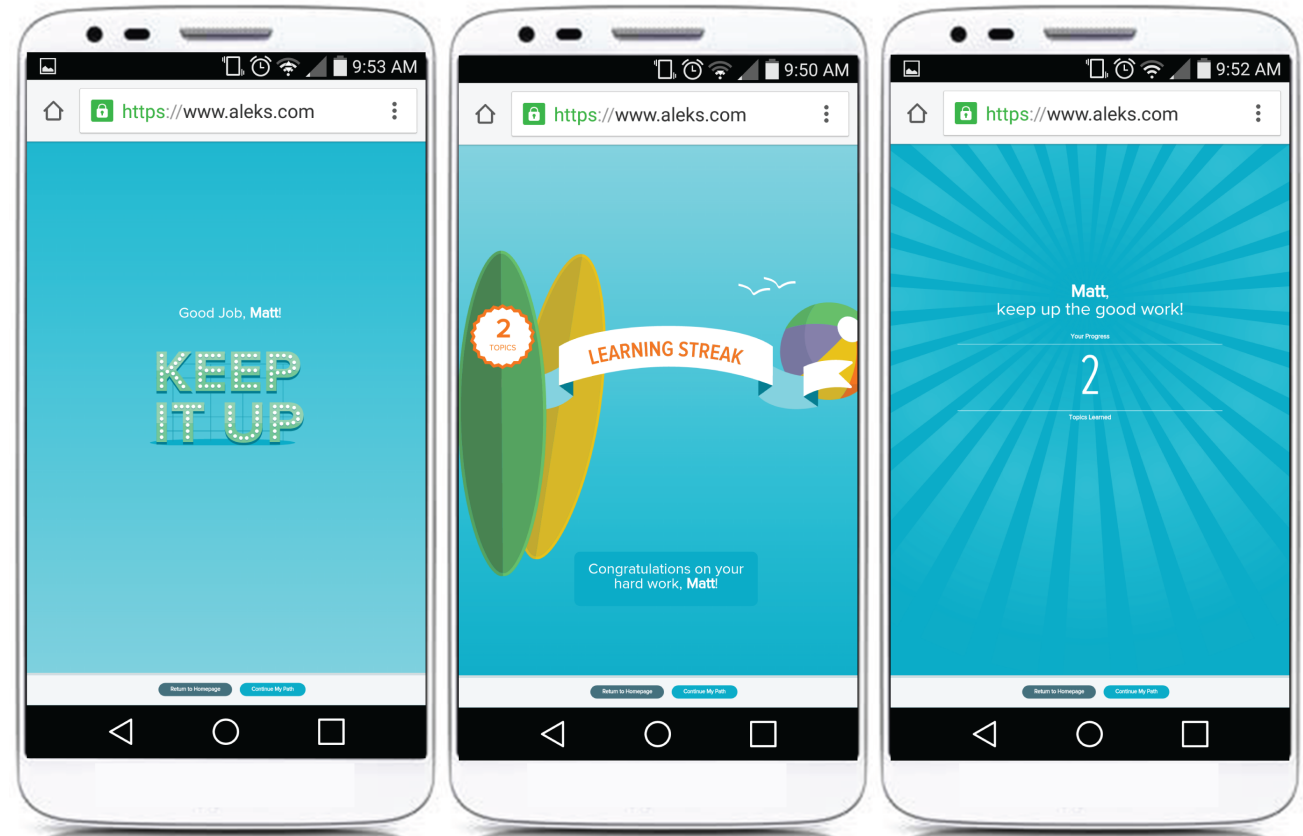

Gradebook

- Too many details in the table for mobile
- Text hard to read

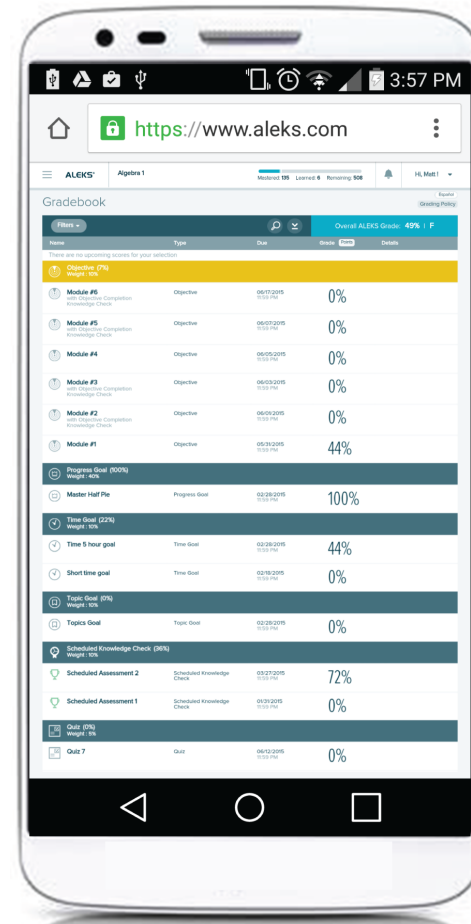

Assignments

- Navigation is too small
- Navigation not collapsible, which would reduce screen real estate if made larger for mobile

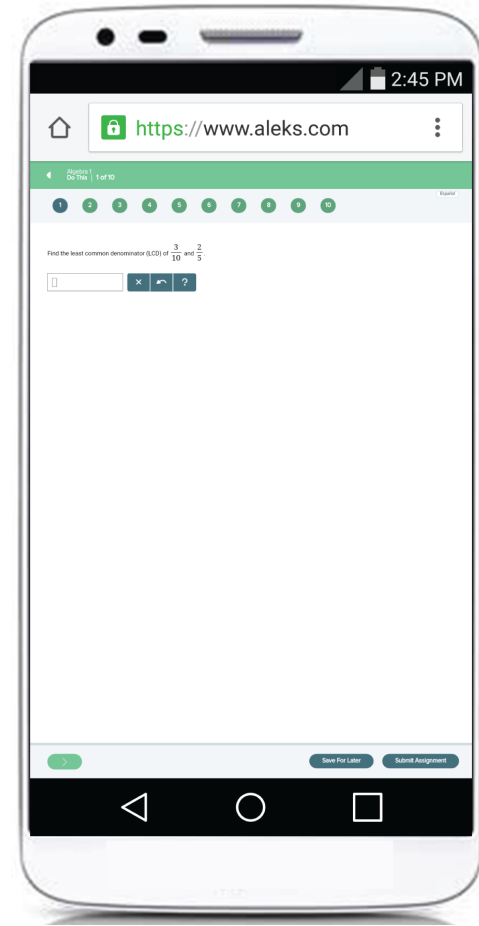

QuickTables

- Lots of unused space
- Keyboard buttons are too small
- The text is difficult to read
- Can't do quick entry

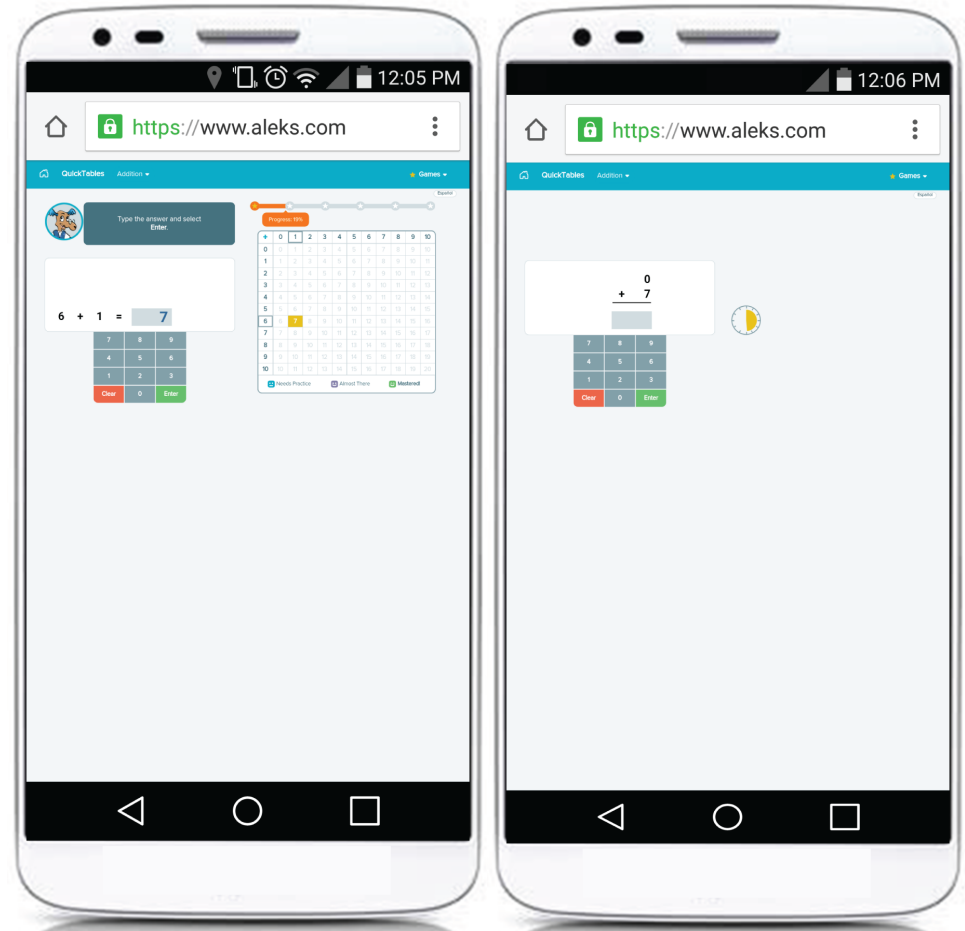



Potential Solutions & Wireframes

Homepage

- Simplified header
- Continue My Path is larger
- Work On Something Else adapts to content
- Non-essential content removed
- Extra header menu

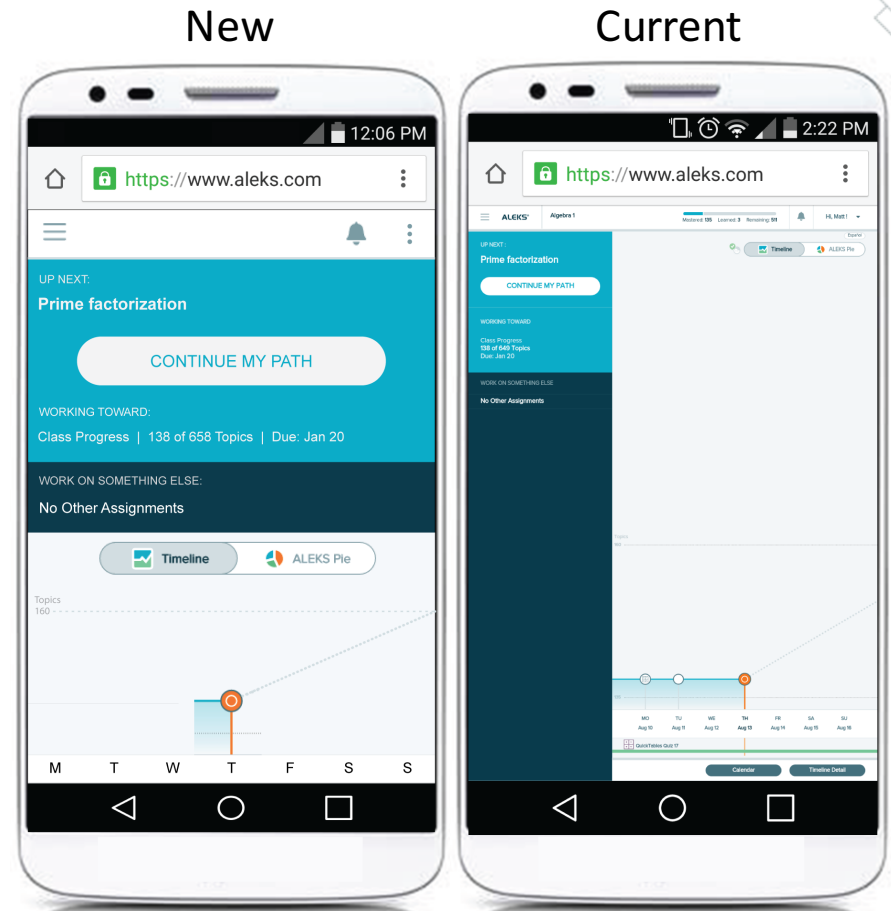

Hamburger Menu

- Menu can scroll if needed

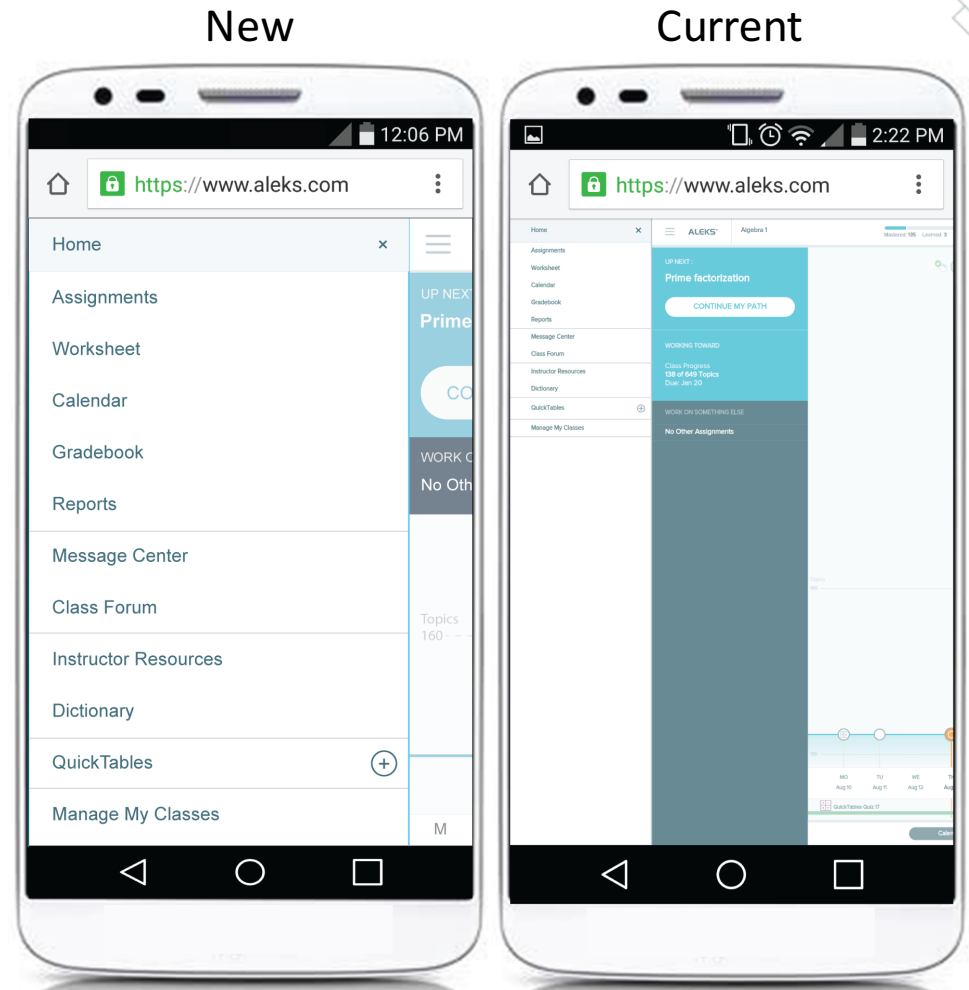

Options Menu (right)

- Possibilities:
 - Hide Work On Something Else when empty
 - Work On Something Else carousel
 - Hide progress bar
 - Working Toward hidden in a menu, twisty, or info button
 - Move guidance area below timeline

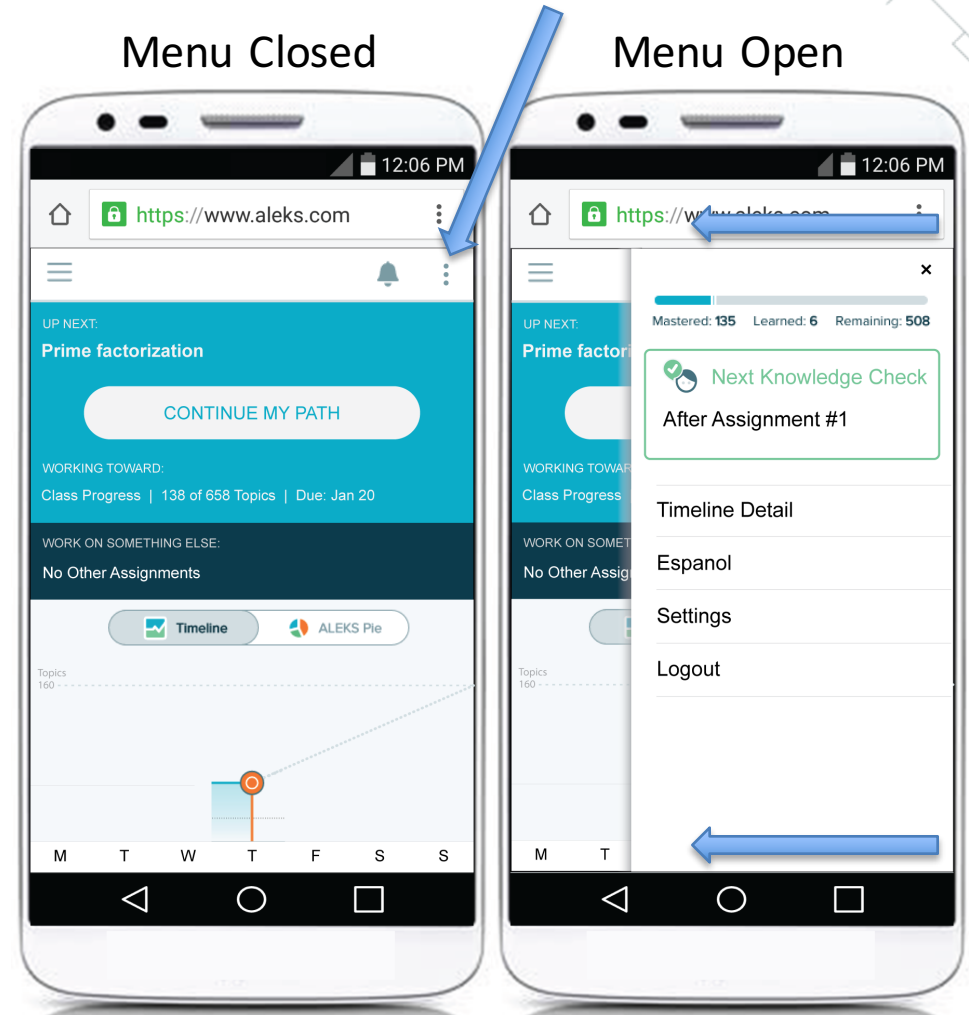

Reports Dashboard

- Enlarge tiles
- Make entire tile clickable
- Scroll vertically, or
- Paginate with 4 tiles per page

Scrolling

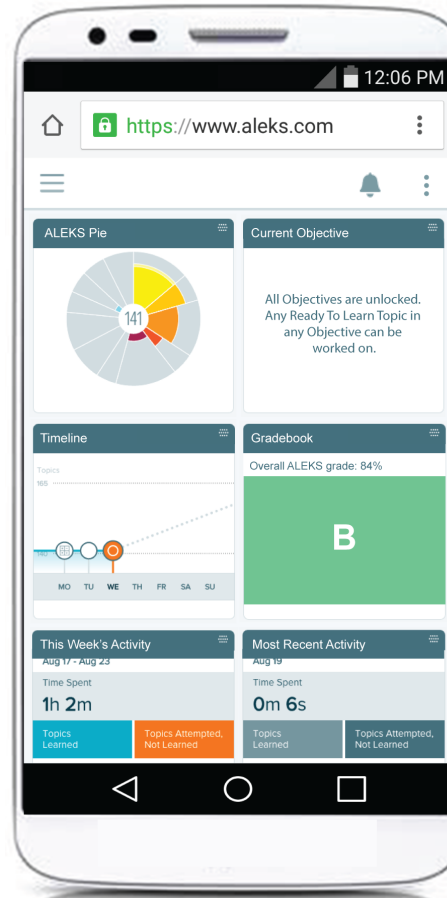

4x4 Pagination

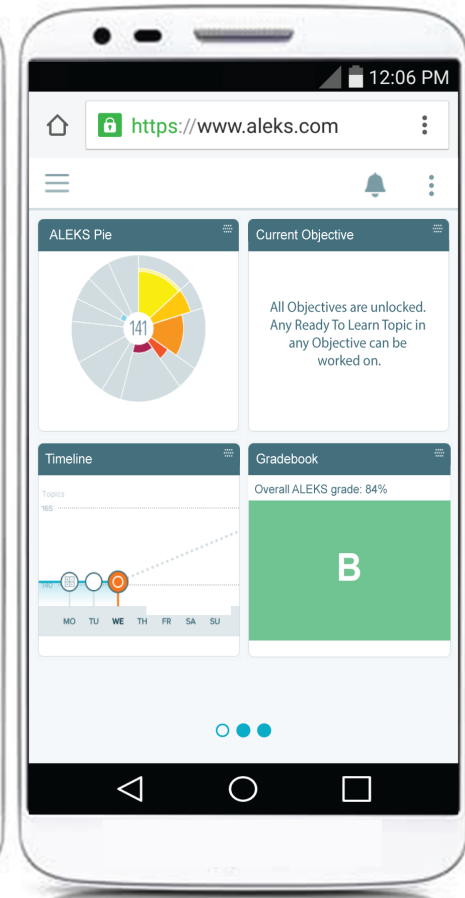

Reports

- Potentially skip dashboard and load first report
- Use dropdown to select other reports

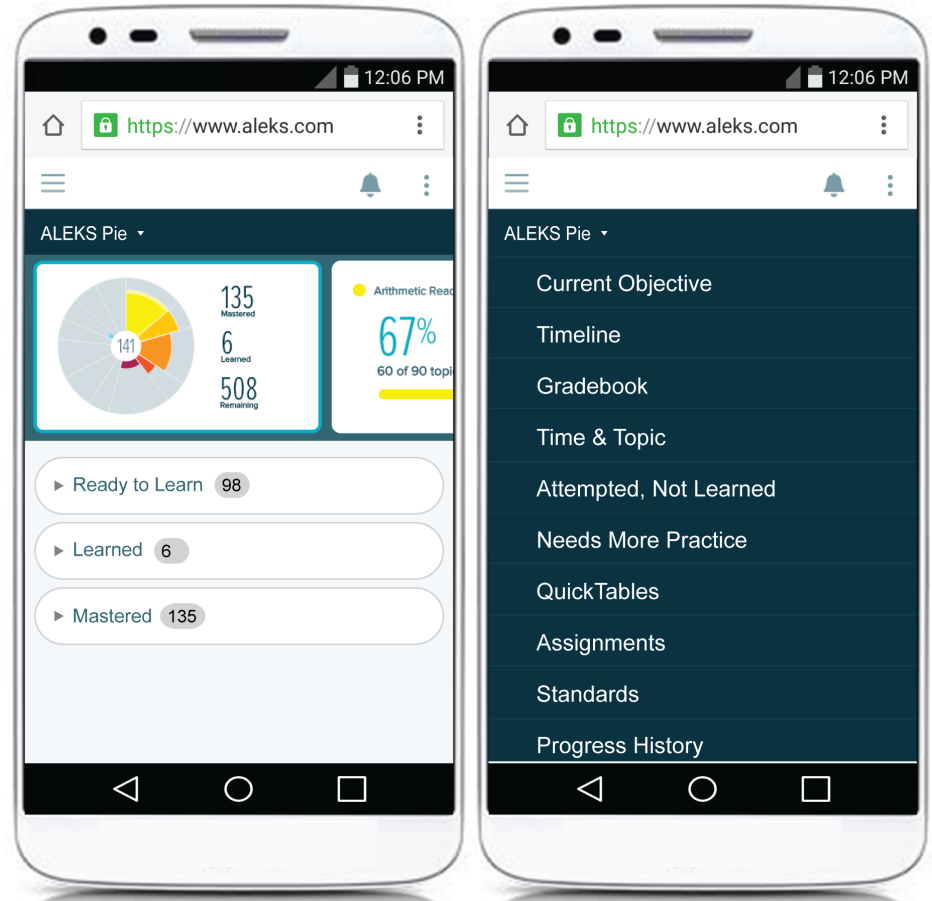

Carousel

- Larger cards
- Show one card at a time, swipe
- Increase start button size
- Scrollable lesson preview
- Move filters to menu

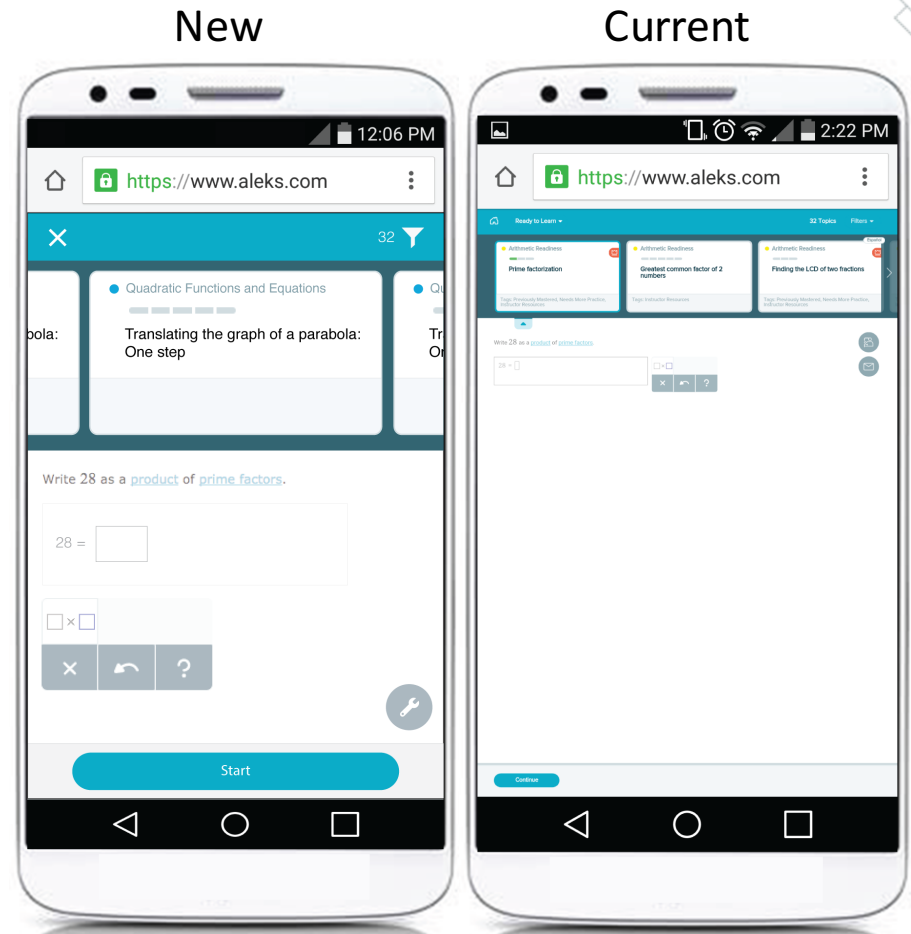

Gradebook

- Reduce the amount of options/info
- Enlarge text
- Hide some options
- Remove non-essential copy
- Relocate search and filter buttons - TBD

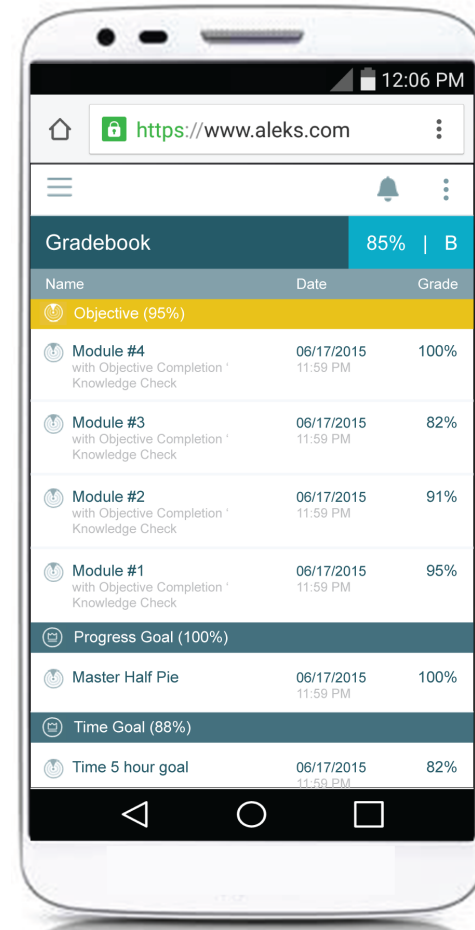

Assignments

- Navigation in dropdown
- Swipe between questions
- Text in title reduced
- Save For Later and Submit Assignment always visible? – TBD
- Navigation collapsible like learning carousel - TBD



QuickTables

- Games dropdown is top right
- Home button top left
- Table selection dropdown in header
- Progress bar visible as needed
- QT Carousel behaves like learning carousel
- Only show facts table when student chooses a fact to work on

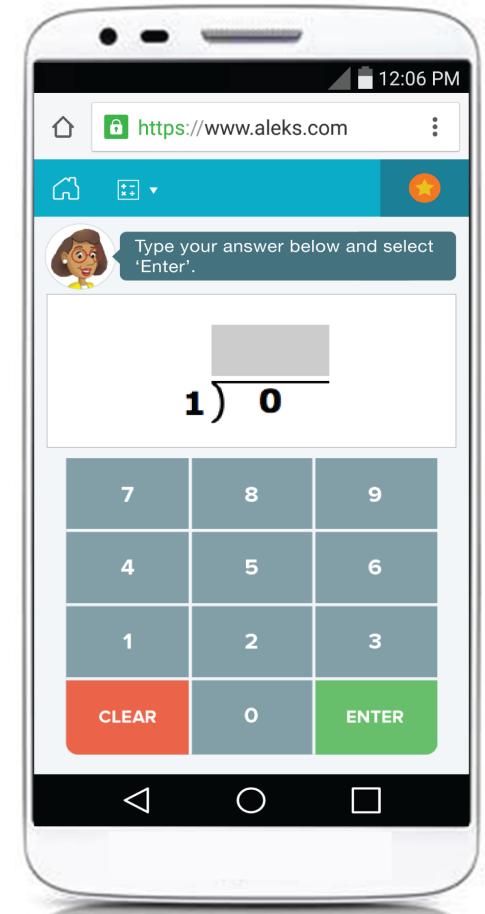

QuickTables

- Table still small, but better
- Could still use scrolling/zooming to show table larger

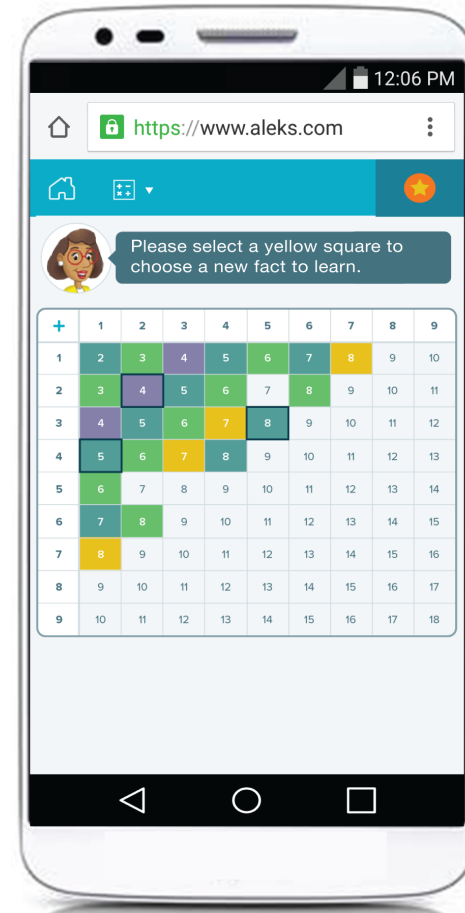

Content V1 – No Change to Content

- No change to content size or optimization
- Hide header
- Instructor resources, slice & topic name, and learning walk hidden in menu (top right)

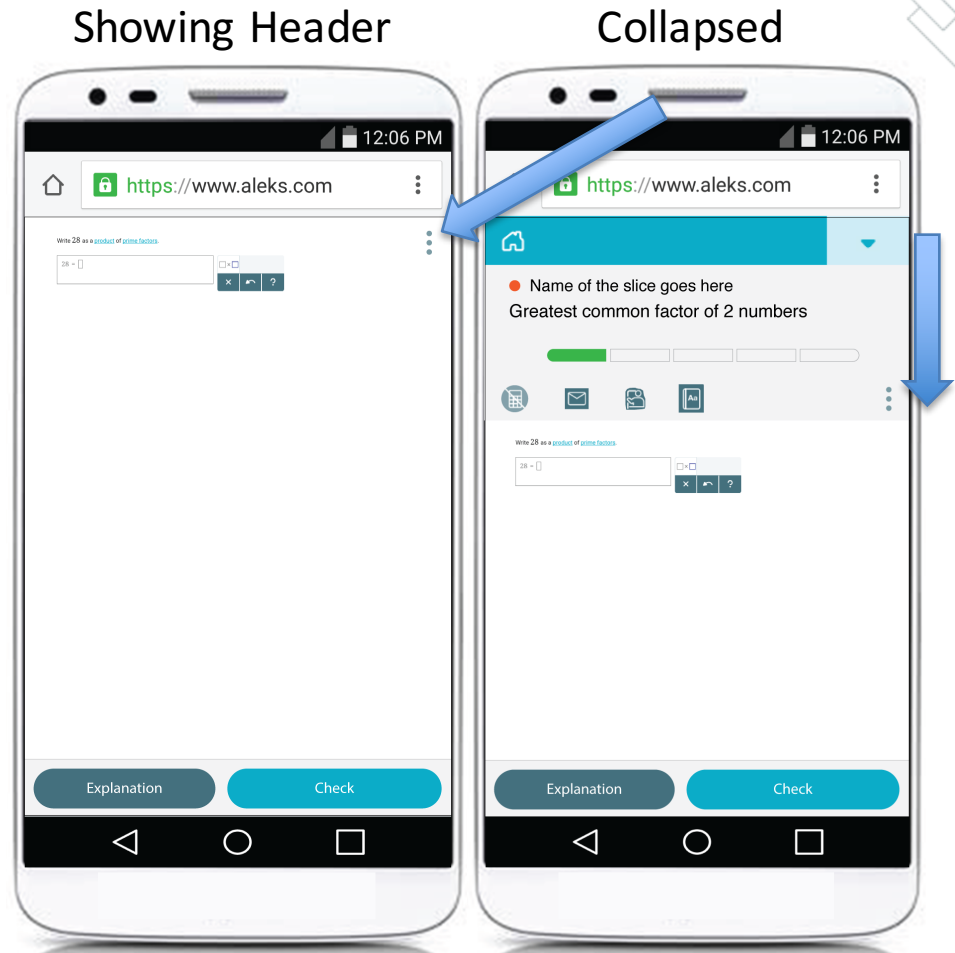

Content V1 – No Change to Content

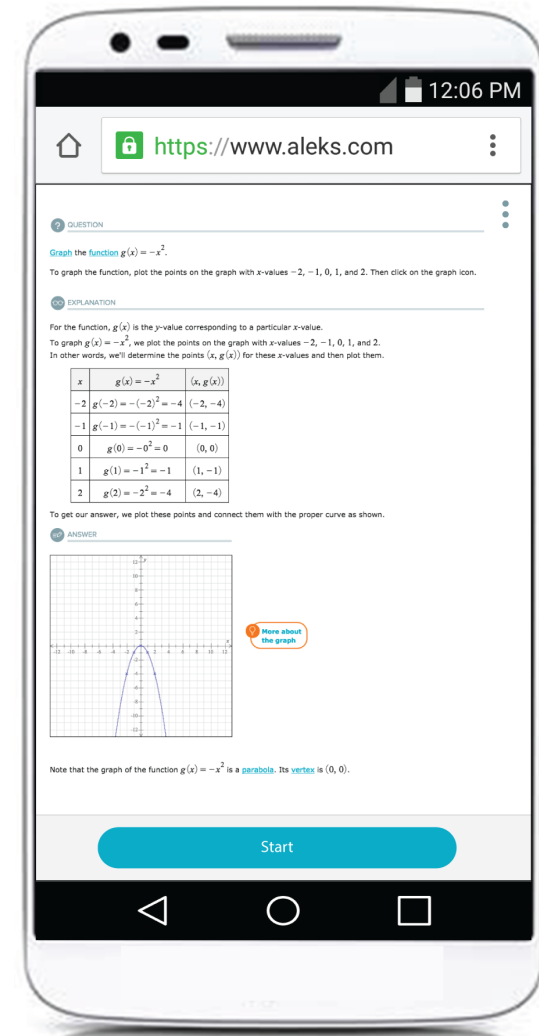
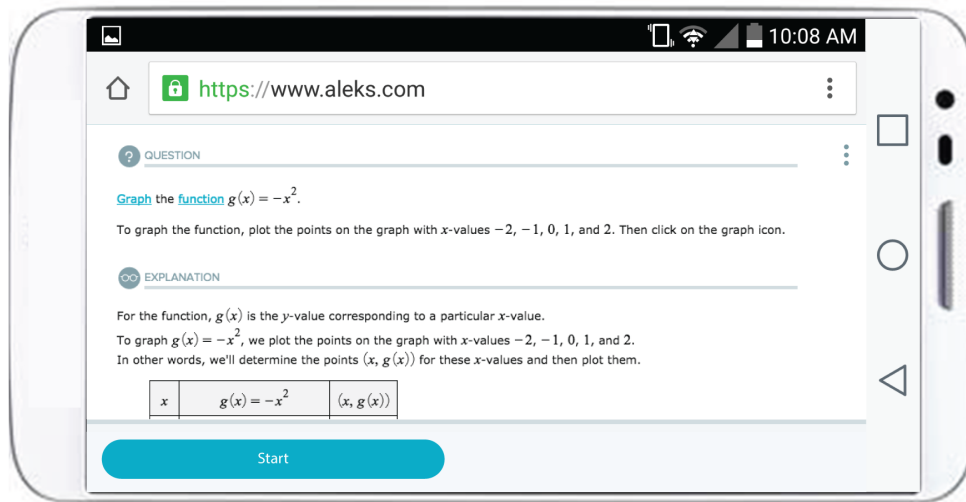

Content V2 – Optimized Content

- Content zoomed in/optimized
- Input tools in expanding drawer, separated from answer editor

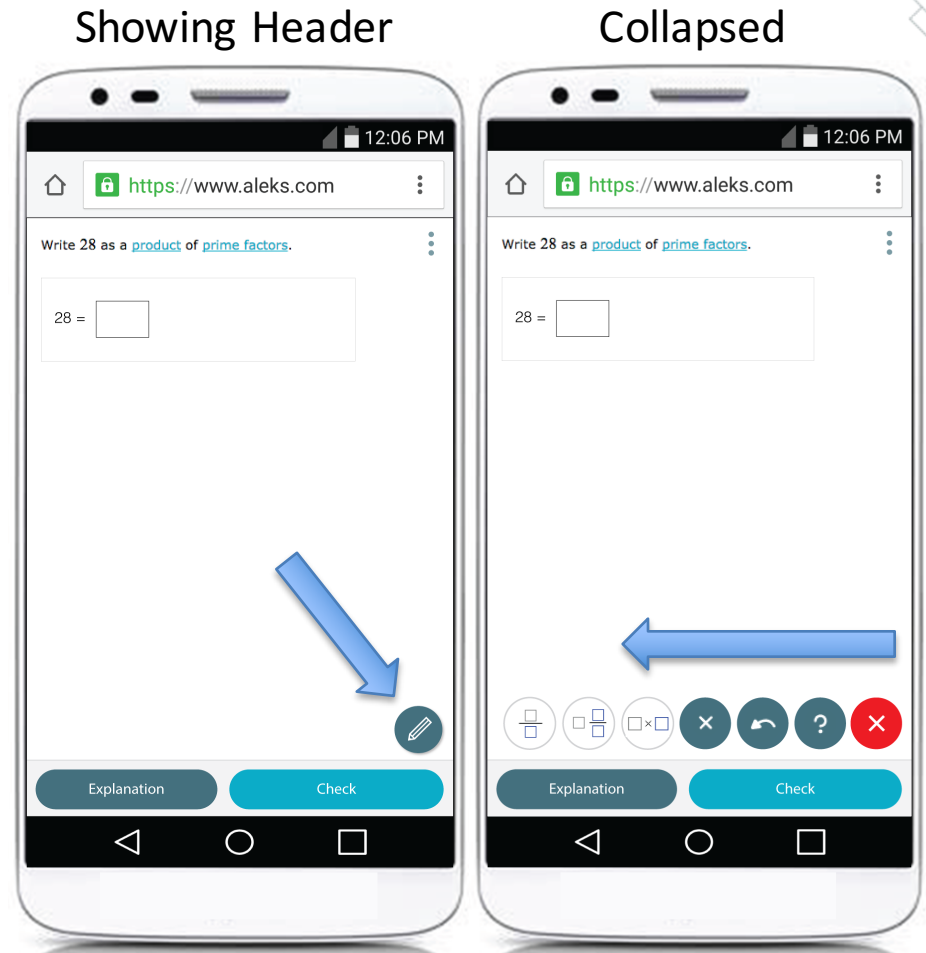

Content V2 - Optimized Content

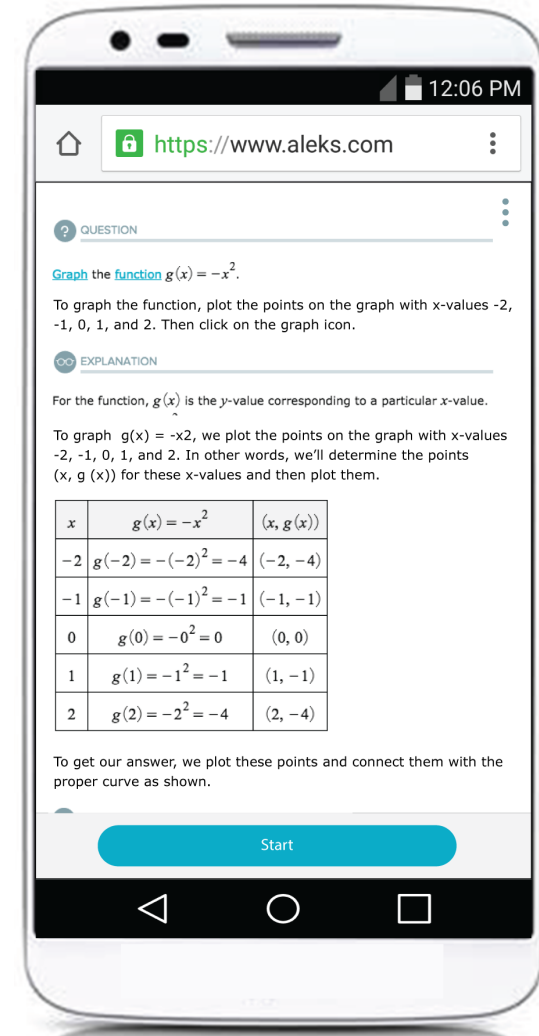
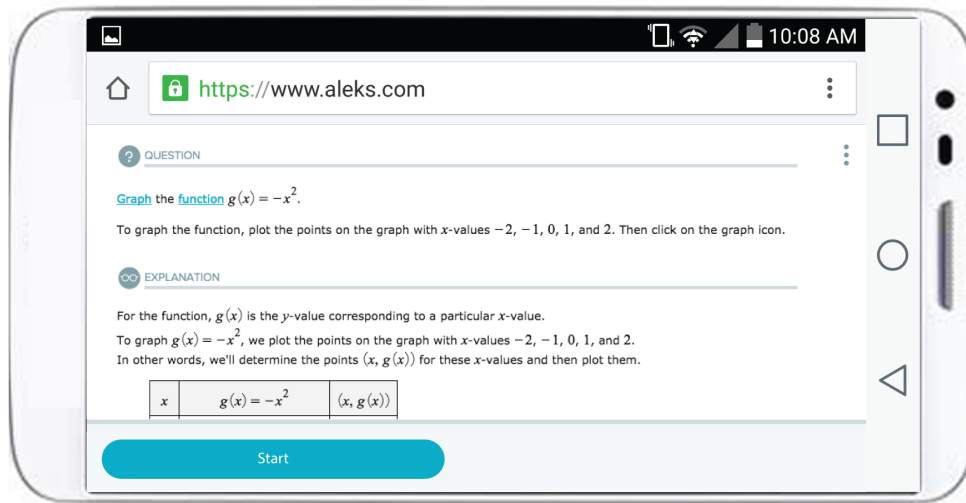

Handling Non-Mobile-Friendly Content

- In v1 and v2, some content will remain not optimized for mobile due to the answer input tools and nature of the content

For the triangles below, use the tools to move the solid triangle exactly onto the dashed one.
Then answer the parts below.

(a) Complete the **congruence** statements below.

$\angle C \cong$ (Choose one) ▼

$\angle D \cong$ (Choose one) ▼

$\angle E \cong$ (Choose one) ▼

(b) Find the following **ratios**.
Write your answers as fractions in **simplest form**.

$\frac{WY}{CD} = \square$ $\frac{YX}{DE} = \square$ $\frac{WX}{CE} = \square$

(c) Select the true statement.

$\triangle CDE$ and $\triangle WYX$ are **similar**.

$\triangle CDE$ and $\triangle WYX$ are **not similar**.

Handling Non-Mobile-Friendly Content

- What we can do:
 - Question text and tool buttons = optimized
 - Tools separate from answer editor Answer editor not optimized
 - Answer editor may still require zooming/scrolling
 - Additional functionality on screen orientation change
 - Tag topics as “Mobile-Friendly” and queue these up in carousel if student is working on a mobile device
 - Show some things only in landscape mode (e.g. calculator)

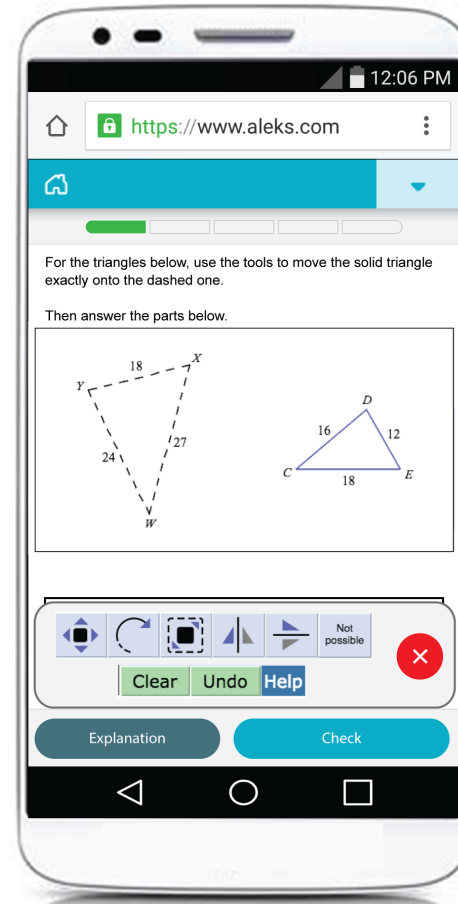

Handling Non-Mobile-Friendly Content

- Here is an example of the calculator in landscape mode

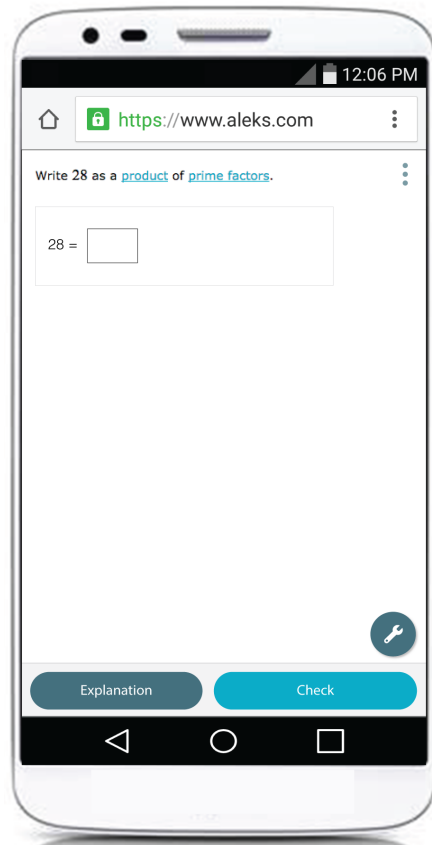

Areas Not Covered in this Deck

- **Platform features** not covered in this slide deck that would be covered upon approval of the project:
 - Landscape Orientation
 - Student Account Home
 - First Time Use
 - Calendar
 - Class Forum
 - Worksheet
 - Dictionary
 - www.aleks.com homepage (for logging in to ALEKS product)
- **Course products** not covered in this slide deck that would be covered upon approval of the project:
 - School desires the entire Suite of Algebra 1 courses to be optimized for mobile
 - HE Math desires Basic Math to PreCalculus
 - International desires LatAm localized course products (TBD)
- Rollout would be course product by course product. Note that a single ALEKS topic typically appears in multiple course products.